

Step 1: Device Assembly

Catheter Tube Assembly and Collection Bag

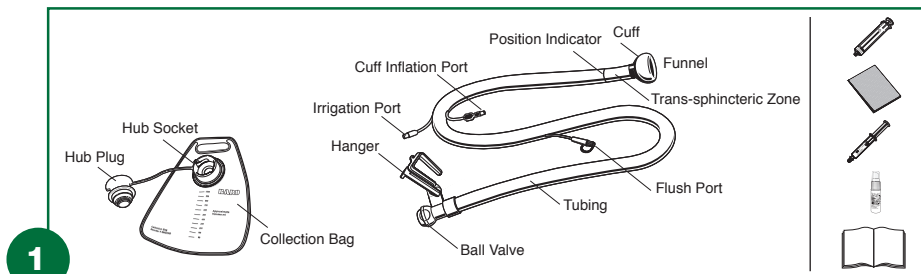

Drainage Tube Ports

The catheter contains three ports

Label	Port Color	Label Definition
"INF(45ML)"	Green (matches the cuff color)	Inflation port for retention cuff, specifies recommended inflation volume and inflation medium
"FLUSH"	Purple	Flush port for clearance of drain tube only
"IRRIG"	Clear	Irrigation port infuses water into rectum

Attaching Collection Bag

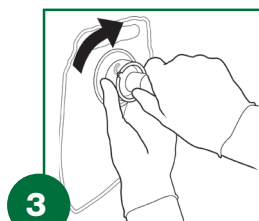

1. Attach the collection bag to catheter by inserting ball valve of catheter into socket connector and turning clockwise until it snaps into place.

Step 2: Patient Preparation/Device Insertion

(A-C) Folding the Retention Cuff

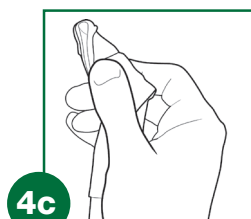
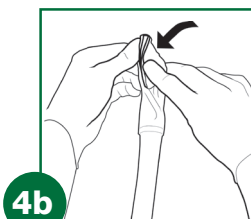
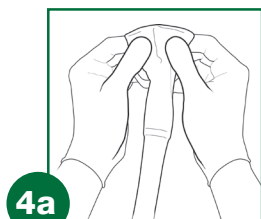

1. Hold the left point of the cuff between the thumb and index finger.
2. Fold the top right point of the cuff down and to the left in a 45 degree angle, in order to create a conical shape with a leading edge for easy insertion.

(D-E) Inserting the Device

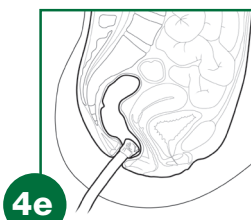
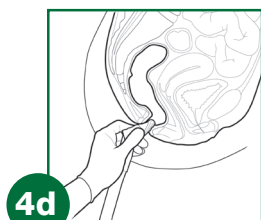

3. Grasp the catheter and gently insert the cuff end through the anal sphincter until the cuff is beyond the external orifice and well inside the rectal vault.

Step 3: Cuff Inflation/Seating

Cuff Inflation

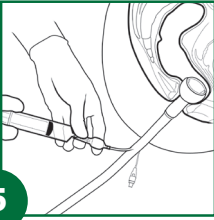

5

1. Inflate the cuff with 45 ml of water by slowly depressing the syringe plunger. As the cuff inflates, the pilot balloon also inflates.

Proper Cuff Placement

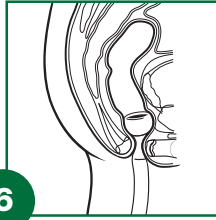

6

1. Remove syringe from inflation port and gently pull on the silicone catheter to check that the cuff is securely in the rectum and positioned against the rectal floor.
2. Note position of indicator line.

BARD
MEDICAL DIVISION

Bard Medical Division
C. R. Bard, Inc.
8195 Industrial Boulevard
Covington, GA 30014
1-800-526-4455
www.bardmedical.com

Bard and Medi-Aire are registered trademarks of C. R. Bard, Inc., or an affiliate. DigniCare is a trademark of C. R. Bard, Inc., or an affiliate. Please consult product label and insert for any indications, contraindications, hazards, warnings, cautions and directions for use.
©2008 C. R. Bard, Inc.
All Rights Reserved.
PK0805-04 R05/08 HIM P05/08 5M

Step 4: Device Maintenance

Irrigation

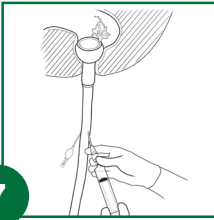

7

1. Fill syringe with tap water.
2. Attach to irrigation port.
3. Depress plunger.

Flushing the Catheter

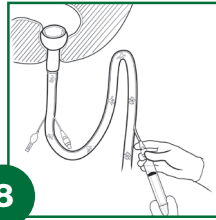

8

1. Fill syringe with tap water.
2. Attach it to "flush" port.
3. Depress plunger.

Bag Removal/Replacement

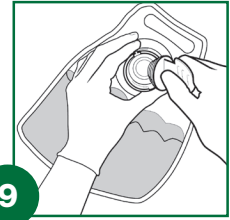

9

1. Grab ball valve connector, gently push in catheter, and twist counterclockwise.
2. Remove bag, insert bag plug into socket connector, and dispose of bag in accordance with institutional protocol for disposal of medical waste.
3. Follow instructions in Fig 3 to replace collection bag.

Step 5: Deflating Retention Cuff/Removing Catheter

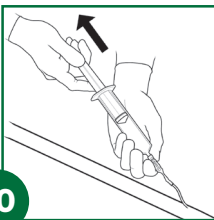

10

1. Attach syringe to inflation port.
2. Slowly withdraw all water from the retention cuff, ensuring inflation port is parallel to catheter.
3. Disconnect syringe and discard.
4. Grasp catheter and slide it out of anus.
5. Dispose of device in accordance with institutional protocol for medical waste.

To order: 1-800-FOR-BARD or www.bardmedical.com

	DigniCare™ Stool Management System	DigniCare™ Collection Bags
Product Code	SMS001	SMS00B
Case Quantity	2	10

DigniCare™ SMS Indications for Use:

The Bard® DigniCare™ Stool Management System (SMS) is intended for fecal management by diverting and collecting liquid or semi-liquid stool to minimize skin contact in bedridden patients. Adult use only.

Medi-aire® Biological Odor Eliminator

Net contents: 1 fl oz (30 ml)

Medi-aire® is a unique, powerful odor eliminator formulated to quickly counteract offensive odors from urine, feces, emesis and even necrotic tissue.